



viewtex

**Programación general / Programação geral
Programmation / Programmazione generale
General programming**

Motores radio BI Baterías y C.C. transformador integrado

Motores rádio BI pilhas e C.C. transformador integrado

Moteurs radio BI batteries et réseau à transformateur intégré

Motori radio BI batterie e C.C. trasformatore integrato

Battery BI radio motors and C.C. integrated transformer

Roller / Box / Banded Shades

viewtex

**Programación general / Programação geral
Programmation / Programmazione generale
General programming**

Motores radio BI Baterías y C.C. transformador integrado
Motores rádio BI pilhas e C.C. transformador integrado
Moteurs radio BI batteries et réseau à transformateur intégré
Motori radio BI batterie e C.C. trasformatore integrato
Battery BI radio motors and C.C. integrated transformer

Roller / Box / Banded Shades

CONTENIDOS

Características emisores	4
1. Proceso de instalación cortinas	5
1.1 Opción 1, cortinas totalmente programadas	5
1.2 Opción 2, cortinas en modo programación	5
2. Modificar finales de carrera	6
2.1 Modificar final de carrera superior	6
2.2 Modificar final de carrera inferior	6
3. Adición de un nuevo emisor	7
3.1 Método 1	7
3.2 Método 2 o pérdida del emisor	7
4. Borrado de un emisor	7
5. Posición preferida	8
5.1 Ajuste de posición preferida	8
5.2 Eliminación de posición preferida	8
6. Borrado total del motor (reset)	9
7. Programación motor desde inicio	10
7.1 Asignación de emisor	10
7.2 Comprobado del sentido de giro	10
7.3 Regulación finales de carrera y cierre de programación	11
8. Funciones botón prog. Cabeza del motor	12

Características emisores

Alcance señal radio: 100 metros sin obstáculos.
20 metros atravesando hasta 2 paredes de hormigón estructural.

Número máx. de mandos o canales asociados a un solo motor:
9 mandos o canales.

Número máx. de motores asociados a un solo mando o canal: Ilimitado.



1. Procedimiento instalación

1.1 Opción cortinas totalmente programadas

PARA LOS SIGUIENTES PEDIDOS

1 cortina con 1 solo emisor

— **O** —

Pedidos de **más de 1 cortina con más de un emisor**, en la que **Si** esté especificada la **asociación mando-cortina**.

Alimentar el motor (solo para motor C.C con transformador integrado).

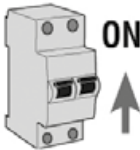

El motor ya funciona con los finales de carrera programados.

1.2 Opción cortinas en modo programación

PARA LOS SIGUIENTES PEDIDOS

Pedidos de **varias cortinas con varios emisores**, en la que **NO** esté especificada la **asociación de mandos**.



Conectar únicamente la cortina que vamos a programar, nunca conectar más de una cortina para realizar este paso del manual.

Alimentar el motor (solo para motor C.C con transformador integrado).



Pulsar «**Prog.**» de la cabeza del motor (aprox 2 seg).



El motor responde

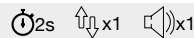

Pulsar «**Stop**» del emisor (aprox 2 seg).



El motor responde



2. Modificación finales de carrera



Para ajustar los finales de carrera que ya vienen programados de según especificaciones del cliente.

2.1 Modificar final de carrera superior

Pulsar simultáneamente «Subida» y «Stop» del emisor (aprox. 5 seg).



El motor responde

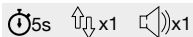

Pulsar «Subida» o «Bajada» hasta nuevo final de carrera superior.

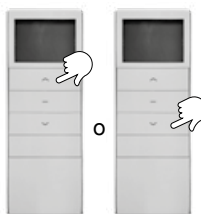

Pulsar simultáneamente «Subida» y «Stop» del emisor (aprox 2 seg).

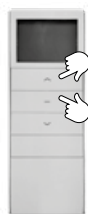

El motor responde

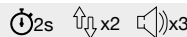

2.2 Modificar final de carrera inferior

Pulsar simultáneamente «Bajada» y «Stop» del emisor (aprox 5 seg).



El motor responde

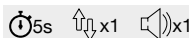

Pulsar «Subida» o «Bajada» hasta nuevo final de carrera inferior.

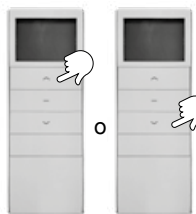

Pulsar simultáneamente «Bajada» y «Stop» del emisor (aprox 2 seg).



El motor responde

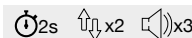

3. Adición de un nuevo emisor

A Emisor o canal programado

B Nuevo emisor o canal a adherir

3.1 Método 1

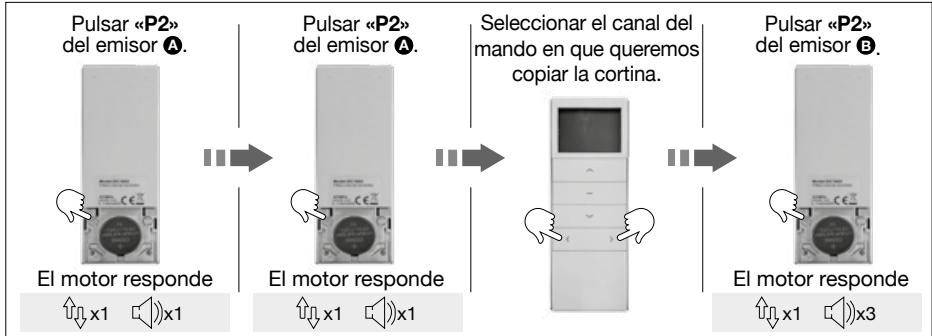

3.2 Método 2 o pérdida del emisor

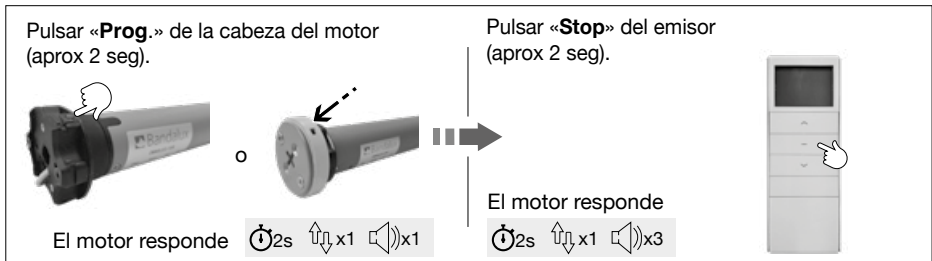

4. Borrado de un emisor

A Emisor o canal programado que queremos conservar

B Emisor o canal programado que queremos eliminar

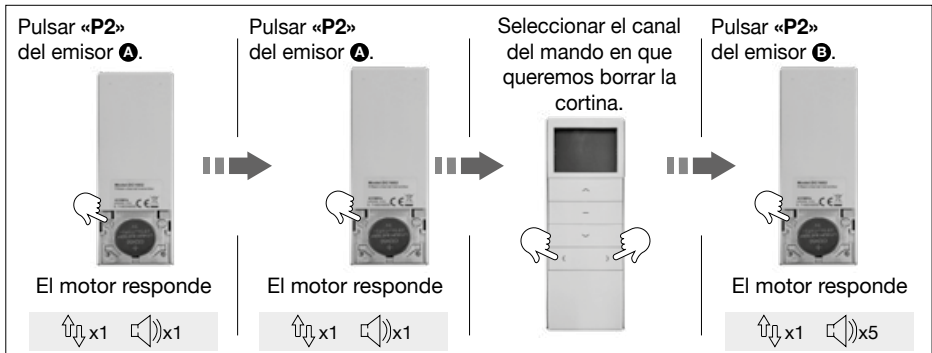

5. Posición preferida

5.1 Ajuste de posición preferida

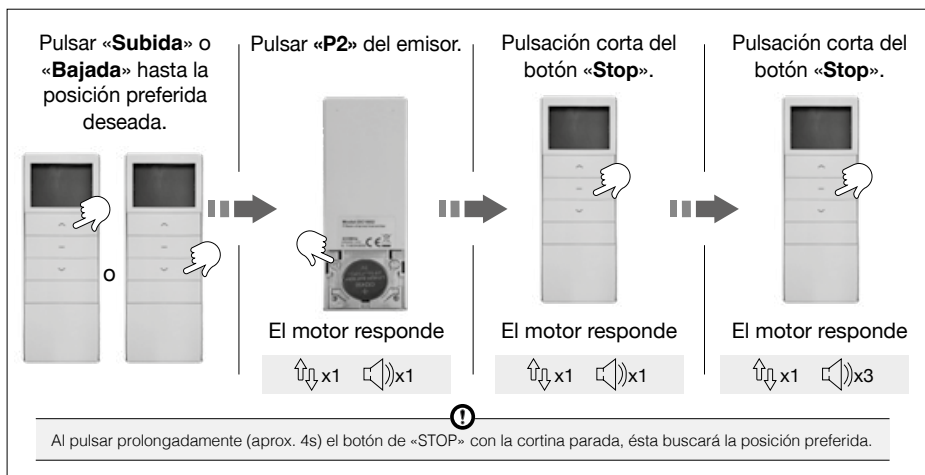

5.2 Eliminación de posición preferida

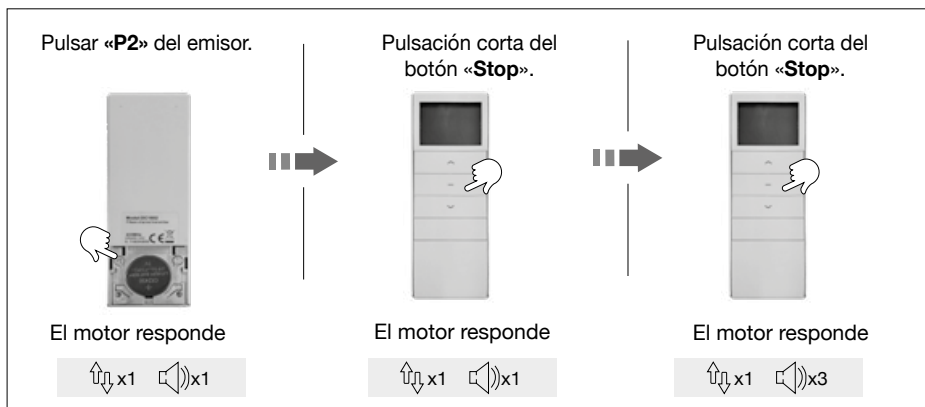

6. Borrado total del motor (RESET)

Pulsar «Prog» de la cabeza del motor (aprox. 14 seg).



El motor responde

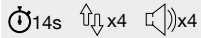

7. Programación de un motor desde el inicio

7.1 Asignación del emisor

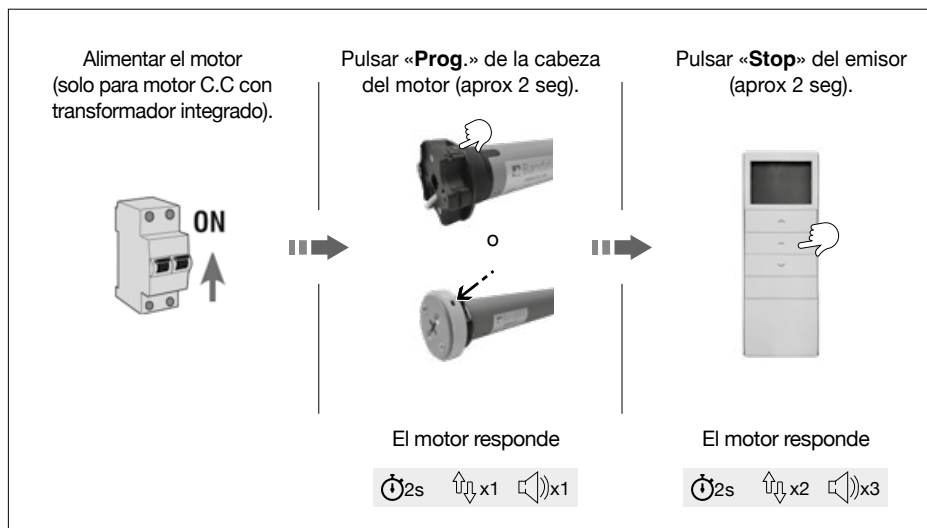

7.2 Comprobación del sentido de giro

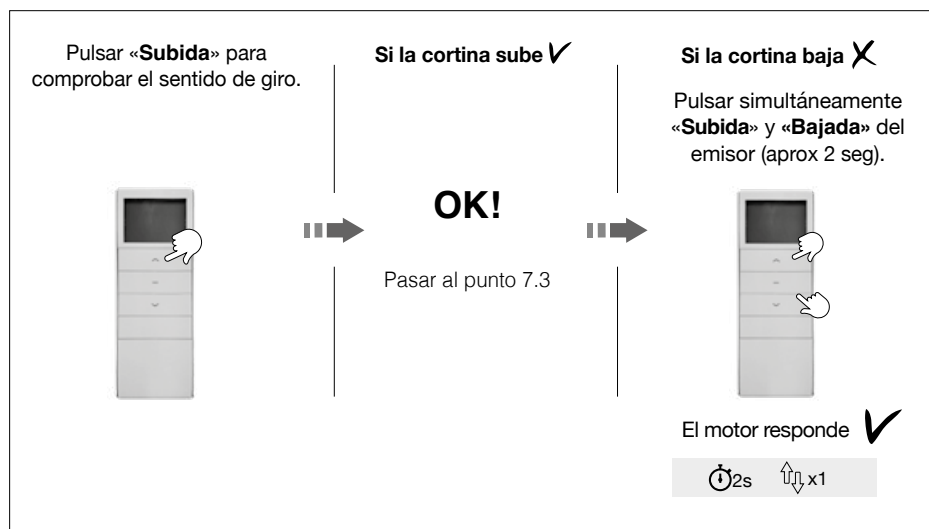

7. Programación de un motor desde el inicio

7.3 Regulación finales carrera y cierre de programación

FINAL CARERRA SUPERIOR

Pulsar «**Subida**» del emisor.



Pulsar «**Stop**» del emisor en el final de carrera superior deseado.



Pulsar simultáneamente «**Subida**» y «**Stop**» del emisor (aprox 2 seg).

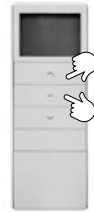

El motor responde

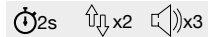

FINAL CARERRA INFERIOR

Pulsar «**Bajada**» del emisor.



Pulsar «**Stop**» del emisor en el final de carrera inferior deseado.



Pulsar simultáneamente «**Bajada**» y «**Stop**» del emisor (aprox 2 seg).



El motor responde

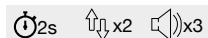

8. Funciones botón «Prog.» cabeza del motor



o



Pulsar «Prog.» de la cabeza del motor el tiempo necesario en función de la acción a realizar, según etapas siguientes:



**Movimiento motor;
Sleep Mode OFF**



Inicio programación; agregar o borrar un nuevo emisor

El motor responde

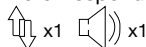

Sleep Mode ON



El motor responde

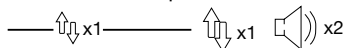

Cambio de sentido de giro



El motor responde

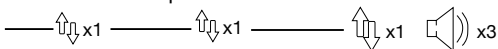

Reset motor



El motor responde

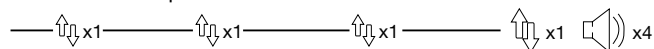

CONTEÚDOS

Características emissores	14
1. Processo de instalação cortinas	15
1.1 Opção 1, cortinas totalmente programadas	15
1.2 Opção 2, cortinas em modo programação	15
2. Alterar finais de curso	16
2.1 Alterar final de curso superior	16
2.2 Alterar final de curso inferior	16
3. Adição de um novo emissor	17
3.1 Método 1	17
3.2 Método 2 ou perda do emissor	17
4. Eliminação de um emissor	17
5. Posição preferida	18
5.1 Ajuste de posição preferida	18
5.2 Eliminação de posição preferida	18
6. Eliminação total do motor (reset)	19
7. Programação motor desde início	20
7.1 Atribuição de emissor	20
7.2 Confirmação do sentido de rotação	20
7.3 Regulação finais de curso e fecho de programação	21
8. Funções tecla prog. Cabeça do motor	22

Características emissores

PT

Alcance sinal rádio: 100 metros sem obstáculos.
20 metros atravessando até 2 paredes de betão estrutural.

Número máx. de comandos ou canais associados a um único motor:
9 comandos ou canais.

Número máx. de motores associados a um único comando ou canal:
ilimitado.

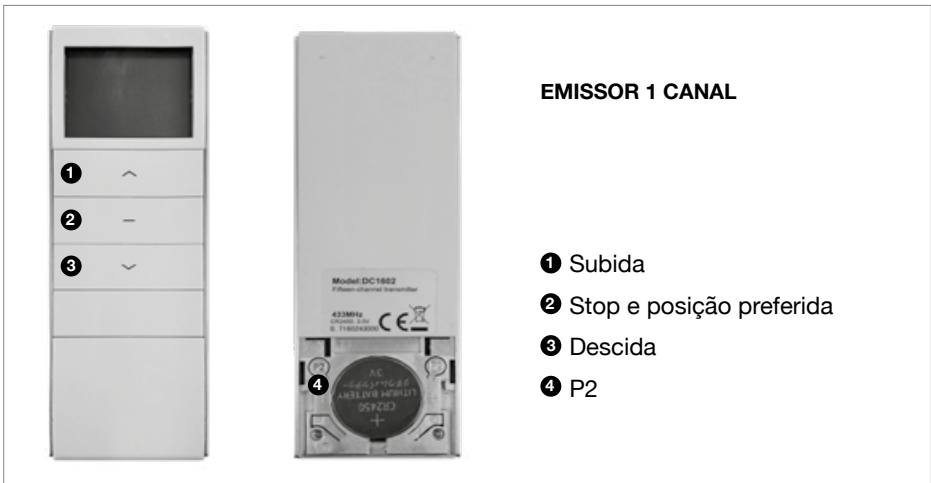

1. Procedimento instalação

1.1 Opção cortinas totalmente programadas

PARA OS SEGUINTE PEDIDOS

**1 cortina com
1 único emissor**

OU

Pedidos de **mais de 1 cortina com mais de um emissor**, em que **SIM** estiver especificada a **associação comando-cortina**.

Alimentar o motor (só para motor C.C. com transformador integrado).

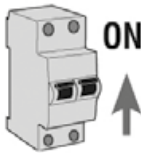

O motor já funciona com os finais de curso programados.

1.2 Opção cortinas em modo programação

PARA OS SEGUINTE PEDIDOS

Pedidos de **várias cortinas com vários emissores**, em que **NÃO** estiver especificada a **associação de comandos**.



Ligar unicamente a cortina que vamos programar, nunca ligar mais de uma cortina para executar este passo do manual.

Alimentar o motor (só para motor C.C. com transformador integrado).



Premir «**Prog.**» da cabeça do motor (aprox. 2 seg.).



O motor responde

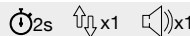

Premir «**Stop**» do emissor (aprox. 2 seg.).



O motor responde

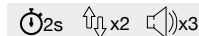

2. Alteração finais de curso



Para ajustar os finais de curso que já vêm programados da conforme especificações do cliente.

PT

2.1 Alterar final de curso superior

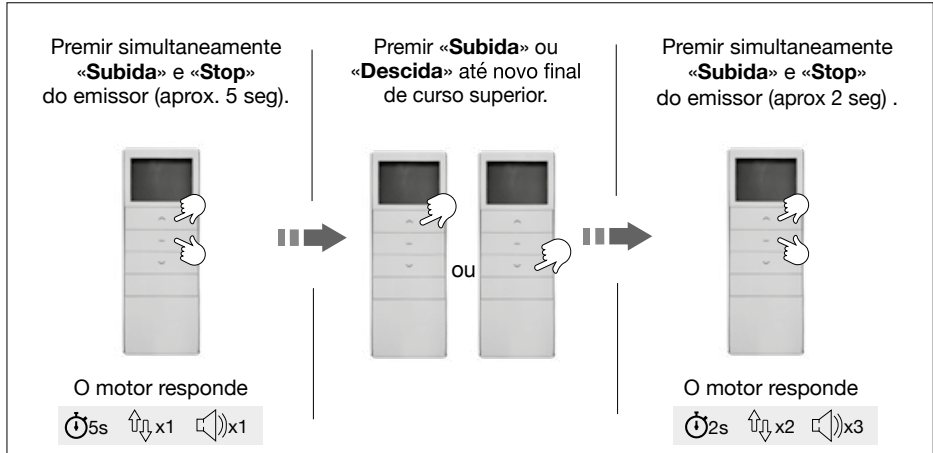

2.2 Alterar final de curso inferior

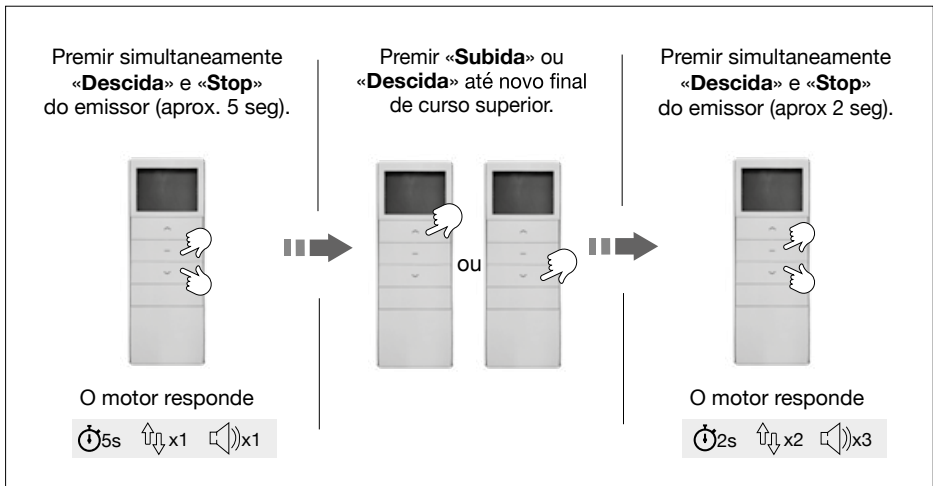

3. Adição de um novo emissor

A Emissor ou canal programado

B Novo emissor ou canal a adicionar

3.1 Método 1

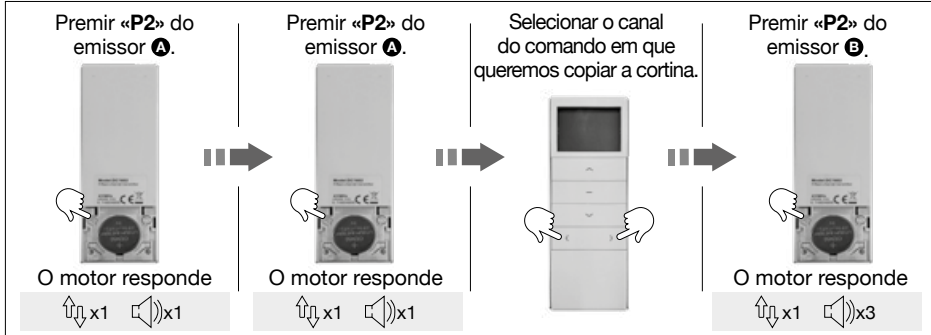

3.2 Método 2 ou perda do emissor

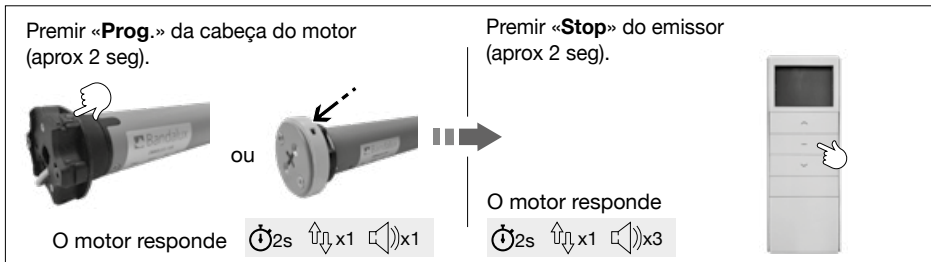

4. Eliminação de um emissor

A Emissor ou canal programado que queremos conservar

B Emissor ou canal programado que queremos eliminar

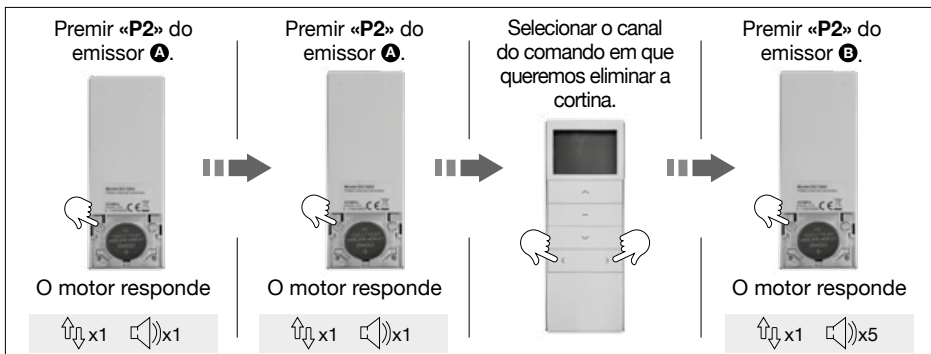

5. Posição preferida

5.1 Ajuste de posição preferida

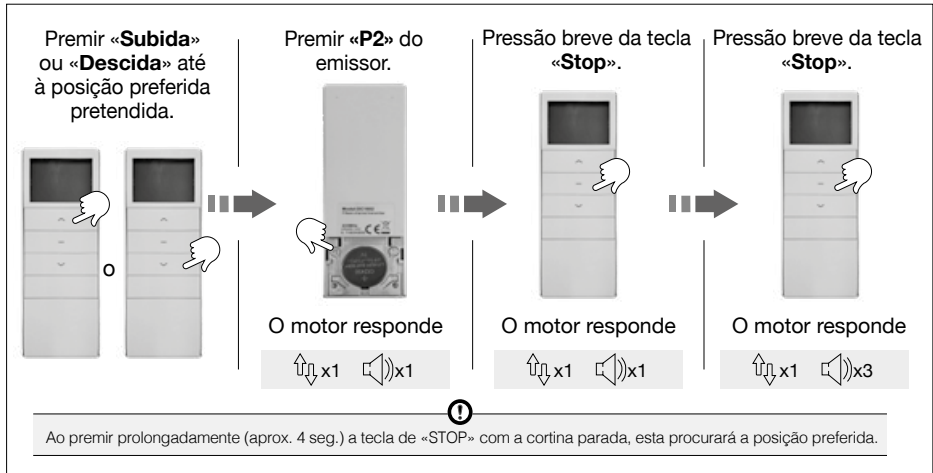

5.2 Eliminação de posição preferida

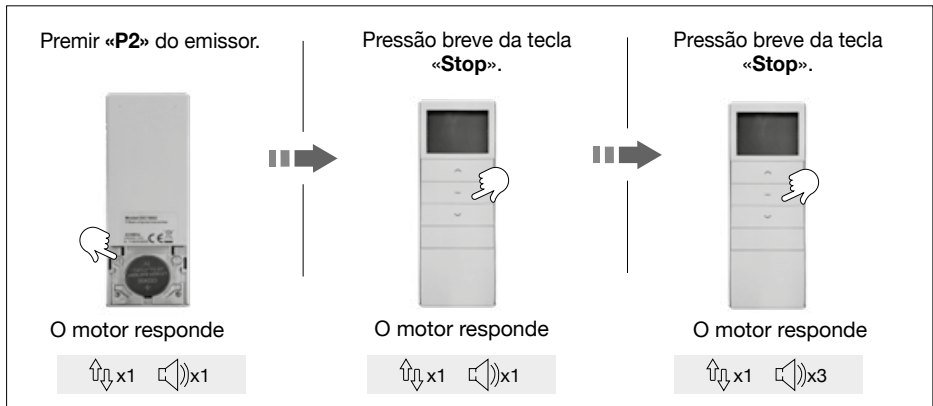

6. Eliminação total do motor (RESET)

Premir «Prog» da cabeça do motor (aprox 14 seg.)

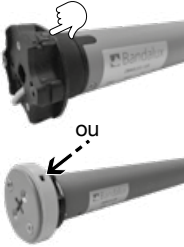

O motor responde

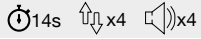

7. Programação de um motor desde o início

7.1 Atribuição do emissor

Alimentar o motor
(só para motor C.C. com
transformador integrado).



Premir «**Prog.**» da cabeça
do motor (aprox 2 seg.)



Premir «**Stop**» do
emissor (aprox 2 seg.).



O motor responde

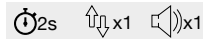

O motor responde



7.2 Confirmação do sentido de rotação

Premir «**Subida**» para
confirmar o sentido de
rotação.



Se a cortina sobe ✓

OK!

Passar ao ponto 7.3

Se a cortina baixa ✗

Premir simultaneamente
«**Subida**» e «**Descida**»
do emissor (aprox 2 seg.).



O motor responde ✓

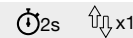

7. Programação de um motor desde o início

7.3 Regulação finais de curso e fecho de programação

FINAL DE CURSO SUPERIOR

Premir «**Subida**» do emissor.



Premir «**Stop**» do emissor no final de curso superior pretendido.



Premir simultaneamente «**Subida**» e «**Stop**» do emissor (aprox 2 seg).



O motor responde

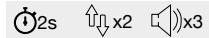

FINAL DE CURSO INFERIOR

Premir «**Descida**» do emissor.



Premir «**Stop**» do emissor no final de curso inferior pretendido.



Premir simultaneamente «**Descida**» e «**Stop**» do emissor (aprox 2 seg).



O motor responde

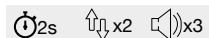

8. Funções tecla «Prog.» cabeça do motor

PT



ou



Premir «**Prog.**» da cabeça do motor o tempo necessário em função da ação a executar, conforme etapas seguintes:



**Movimento motor;
Sleep Mode OFF**



O motor responde

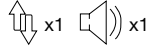

Sleep Mode ON



O motor responde

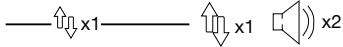

Alteração de sentido de rotação



O motor responde

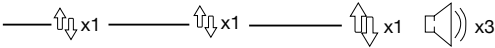

Reset motor



O motor responde

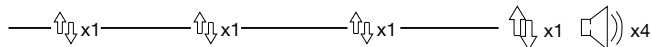

SOMMAIRE

Caractéristiques émetteurs	24
1. Installation stores	25
1.1 Option 1, stores entièrement programmés	25
1.2 Option 2, stores en mode programmation	25
2. Modifier fins de course	26
2.1 Modifier fin de course haute	26
2.2 Modifier fin de course basse	26
3. Ajout d'un nouvel émetteur	27
3.1 Méthode 1	27
3.2 Méthode 2 ou perte de l'émetteur	27
4. Remise à zéro d'un émetteur	27
5. Position favorite	28
5.1 Réglage de la position favorite	28
5.2 Suppression de la position favorite	28
6. Remise à zéro du moteur (reset)	29
7. Programmation moteur depuis le début	30
7.1 Assignation d'émetteur	30
7.2 Vérification du sens de rotation	30
7.3 Réglage fins de course et fin de programmation	31
8. Fonctions bouton prog. Tête du moteur	32

Caractéristiques émetteurs

Portée signal radio : 100 mètres sans obstacle.
20 mètres à travers 2 murs en béton armé.

Nombre max. de commandes ou canaux associés à un seul moteur :
9 commandes ou canaux.

Nombre max. de moteurs associés à une seule commande ou canal :
Illimité.

FR



ÉMETTEUR 1 CANAL

- 1 Montée
- 2 Arrêt et position favorite
- 3 Descente
- 4 P2



ÉMETTEUR 15 CANAUX

Le canal 0 ne peut pas être associé ; tout ce qui est associé aux autres canaux est associé à ce canal automatiquement.

- 1 Montée
- 2 Arrêt et position favorite
- 3 Descente
- 4 Sélection canal : En descente
- 5 Sélection canal : En montée
- 6 P2

1. Installation

1.1 Option stores entièrement programmés

POUR LES PROCHAINES COMMANDES

1 store et 1 seul émetteur — **OU** — Commandes de **plus d'un store avec plus d'un émetteur**, pour lequel est **BIEN** spécifiée l'**association commande-store**.

Mettre le moteur sous tension (uniquement pour moteur C.C avec transformateur intégré).



Le moteur fonctionne déjà avec les fins de course programmées.

1.2 Option stores en mode programmation

POUR LES PROCHAINES COMMANDES

Commandes de **plusieurs stores avec plusieurs émetteurs**, pour lesquels n'est **PAS** spécifiée l'**association commande-store**.

Relier uniquement le store à programmer, ne jamais relier plus d'un store pour cette étape de la procédure.

Mettre le moteur sous tension (uniquement pour moteur C.C avec transformateur intégré).



Appuyer sur le bouton « **Prog.** » de la tête du moteur (env. 2 sec.).

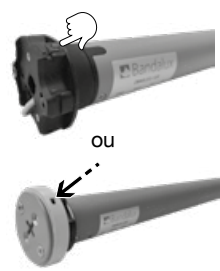

Le moteur répond
⌚ 2s ⬆️⬆️ x1 🔊 x1



Appuyer sur le bouton « **Arrêt** » de l'émetteur (env. 2 sec.).



Le moteur répond
⌚ 2s ⬆️⬆️ x2 🔊 x3

2. Modification fins de course



Pour régler les fins de cours déjà programmées par selon les spécifications du client.

2.1 Modifier fin de course haute

Appuyer simultanément sur les boutons «**Montée**» et «**Arrêt**» de l'émetteur (env. 5 sec.).

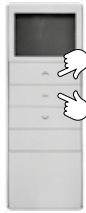

Le moteur répond

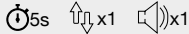

Appuyer sur «**Montée**» ou «**Descente**» jusqu'à la nouvelle fin de course haute.

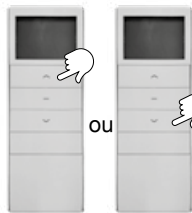

Appuyer simultanément sur les boutons «**Montée**» et «**Arrêt**» de l'émetteur (env. 2 sec.).



Le moteur répond

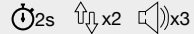

2.2 Modifier fin de course basse

Appuyer simultanément sur les boutons «**Descente**» et «**Arrêt**» de l'émetteur (env. 5 sec.).



Le moteur répond

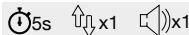

Appuyer sur «**Montée**» ou «**Descente**» jusqu'à la nouvelle fin de course basse.



Appuyer simultanément sur les boutons «**Descente**» et «**Arrêt**» de l'émetteur (env. 2 sec.).



Le moteur répond

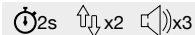

3. Ajout d'un nouvel émetteur

A Émetteur ou canal programmé

B Nouvel émetteur ou canal à ajouter

3.1 Méthode 1

Appuyer sur le bouton «P2» de l'émetteur **A**.

Appuyer sur le bouton «P2» de l'émetteur **A**.

Sélectionner le canal de la commande sur lequel ajouter le store.

Appuyer sur le bouton «P2» de l'émetteur **B**.

Le moteur répond \updownarrow x1 🔊 x1

Le moteur répond \updownarrow x1 🔊 x1

Le moteur répond \updownarrow x1 🔊 x3

3.2 Méthode 2 ou perte de l'émetteur

Appuyer sur le bouton «Prog.» de la tête du moteur (env. 2 sec.).

Appuyer sur le bouton «Arrêt» de l'émetteur (env. 2 sec.).

Le moteur répond 🕒 2s \updownarrow x1 🔊 x1

Le moteur répond 🕒 2s \updownarrow x1 🔊 x3

4. Remise à zéro d'un émetteur

A Émetteur ou canal programmé à conserver

B Émetteur ou canal programmé à supprimer

Appuyer sur le bouton «P2» de l'émetteur **A**.

Appuyer sur le bouton «P2» de l'émetteur **A**.

Sélectionner le canal de la commande sur lequel supprimer le store.

Appuyer sur le bouton «P2» de l'émetteur **B**.

Le moteur répond \updownarrow x1 🔊 x1

Le moteur répond \updownarrow x1 🔊 x1

Le moteur répond \updownarrow x1 🔊 x5

5. Position favorite

5.1 Réglage de la position favorite

Appuyer sur « **Montée** » ou « **Descente** » jusqu'à la fin de course souhaitée.

Appuyer sur le bouton « **P2** » de l'émetteur.

Appui bref sur le bouton « **Arrêt** ».

Appui bref sur le bouton « **Arrêt** ».

Le moteur répond \updownarrow x1 || x1

Le moteur répond \updownarrow x1 || x1

Le moteur répond \updownarrow x1 || x3

!

Un appui long (env. 4 s) sur le bouton « **ARRÊT** » quand le store est à l'arrêt permet de chercher la position favorite.

5.2 Suppression de la position favorite

Appuyer sur le bouton « **P2** » de l'émetteur.

Appui bref sur le bouton « **Arrêt** ».

Appui bref sur le bouton « **Arrêt** ».

Le moteur répond \updownarrow x1 || x1

Le moteur répond \updownarrow x1 || x1

Le moteur répond \updownarrow x1 || x3

6. Remise à zéro du moteur (RESET)

Appuyer sur le bouton «**Prog**» de la tête du moteur (env. 14 sec.).

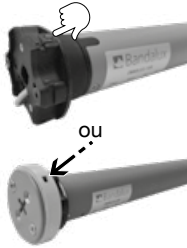

Le moteur répond

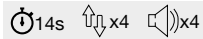

7. Programmation d'un moteur depuis le début

7.1 Assignation d'un émetteur

Mettre le moteur sous tension (uniquement pour moteur C.C avec transformateur intégré).



Appuyer sur le bouton « **Prog.** » de la tête du moteur (env. 2 sec.).



Le moteur répond

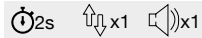

Appuyer sur « **Arrêt** » de l'émetteur (env. 2 sec.).



Le moteur répond

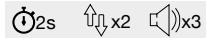

FR

7.2 Vérification du sens de rotation

Appuyer sur « **Montée** » pour vérifier le sens de rotation.



Si le store monte ✓

OUI!

Aller au point 7.3

Si le store descend ✗

Appuyer simultanément sur les boutons « **Montée** » et « **Descente** » de l'émetteur (env. 2 sec.).



Le moteur répond ✓



7. Programmation d'un moteur depuis le début

7.3 Réglage fin de course et programmation

FIN DE COURSE HAUTE

Appuyer sur « **Montée** » de l'émetteur.



Appuyer sur « **Arrêt** » de l'émetteur à la fin de course haute souhaitée.



Appuyer simultanément sur les boutons « **Montée** » et « **Arrêt** » de l'émetteur (env. 2 sec.).



Le moteur répond

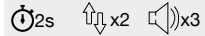

FIN DE COURSE BASSE

Appuyer sur « **Descente** » de l'émetteur.



Appuyer sur « **Arrêt** » de l'émetteur à la fin de course basse souhaitée.



Appuyer simultanément sur les boutons « **Descente** » et « **Arrêt** » de l'émetteur (env. 2 sec.).



Le moteur répond

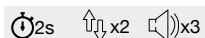

FR

8. Fonctions bouton « Prog. » tête du moteur



ou





Appuyer sur le bouton « Prog. » de la tête du moteur le temps nécessaire en fonction de l'action à réaliser en suivant les étapes suivantes :

FR

 **Mouvement moteur; Sleep Mode OFF**



Début programmation ; ajouter un nouvel émetteur

Le moteur répond

 —————  x1  x1

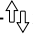

Sleep Mode ON

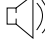
Le moteur répond

 —————  x1 —————  x1  x2

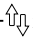
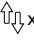

Changement de sens de rotation

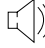
Le moteur répond

 —————  x1 —————  x1 —————  x1  x3

Reset moteur

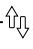
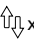
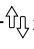
Le moteur répond

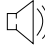
 —————  x1 —————  x1 —————  x1 —————  x1  x4

INDICE

Caratteristiche emittenti	34
1. Processo di installazione tende	35
1.1 Opzione 1, tende totalmente programmate	35
1.2 Opzione 2, tende in modalità programmazione	35
2. Modificare finecorsa	36
2.1 Modificare finecorsa superiore	36
2.2 Modificare finecorsa inferiore	36
3. Aggiunta di nuovo emittente	37
3.1 Metodo 1	37
3.2 Metodo 2 o perdita dell'emittente	37
4. Cancellazione di un emittente	37
5. Posizione preferita	38
5.1 Regolazione della posizione preferita	38
5.2 Eliminazione della posizione preferita	38
6. Cancellazione totale del motore (reset)	39
7. Programmazione motore dall'inizio	40
7.1 Assegnazione emittente	40
7.2 Verifica del senso di rotazione	40
7.3 Regolazione finecorsa e chiusura programmazione	41
8. Funzioni pulsante prog. Testa del motore	42

Caratteristiche emittenti

Portata segnale radio: 100 metri senza ostacoli.
20 metri attraverso fino a 2 pareti in calcestruzzo strutturale.

Numero max. di comandi o canali associati a un solo motore:
9 comandi o canali.

Numero max. di motori associati a un solo comando o canale: Illimitato.



EMITTENTE 1 CANALE

- ❶ Salita
- ❷ Stop e posizione preferita
- ❸ Discesa
- ❹ P2



EMITTENTE 15 CANALI

Il canale 0 non è associabile, tutto ciò che associamo al resto dei canali viene associato automaticamente a questo canale.

- ❶ Salita
- ❷ Stop e posizione preferita
- ❸ Discesa
- ❹ Selezione canale: Discendente
- ❺ Selezione canale: Ascendente
- ❻ P2

1. Procedimento installazione

1.1 Opzione tende totalmente programmate

PER I SEGUENTI ORDINI

1 tenda con 1 solo emittente

O

Ordini di **più di 1 tenda con più di un emittente**, in cui **Si** viene specificata la **associazione comando-tenda**.

Alimentare il motore (solo per motore C.C. con trasformatore integrato).

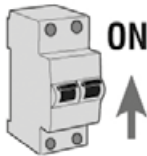

Il motore funziona già con i fincorsa programmati.

1.2 Opzione tende in modalità programmazione

PER I SEGUENTI ORDINI

Ordini di **varie tende con vari emittenti**, in cui **NON** viene specificata l'**associazione dei comandi**.



Collegare solo la tenda che si deve programmare, mai collegare più di una tenda per realizzare questo passaggio del manuale.

Alimentare il motore (solo per motore C.C. con trasformatore integrato).



Premere «**Prog.**» della testa del motore (circa 2 sec).



Il motore risponde

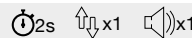

Premere «**Stop**» dell'emittente (circa 2 sec).



Il motore risponde

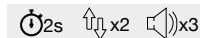

2. Modificare finecorsa



Per regolare i finecorsa che vengono già programmati da in base alle specifiche del cliente.

2.1 Modificare finecorsa superiore

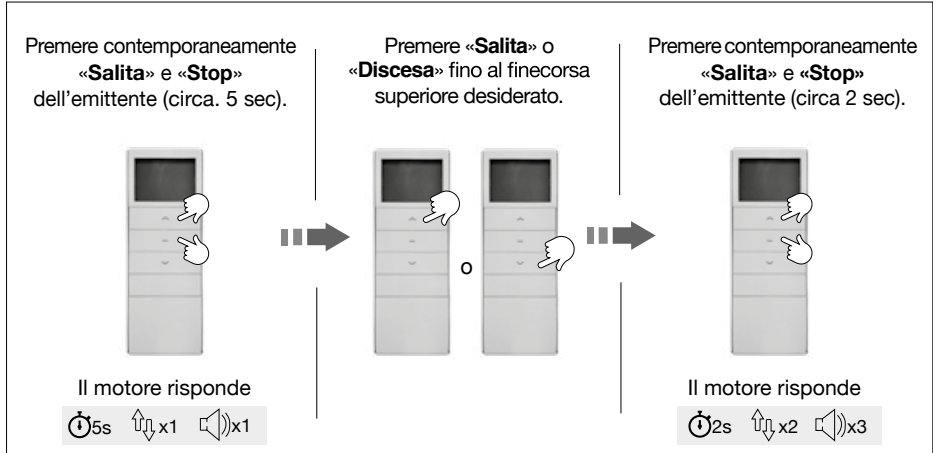

2.2 Modificare finecorsa inferiore

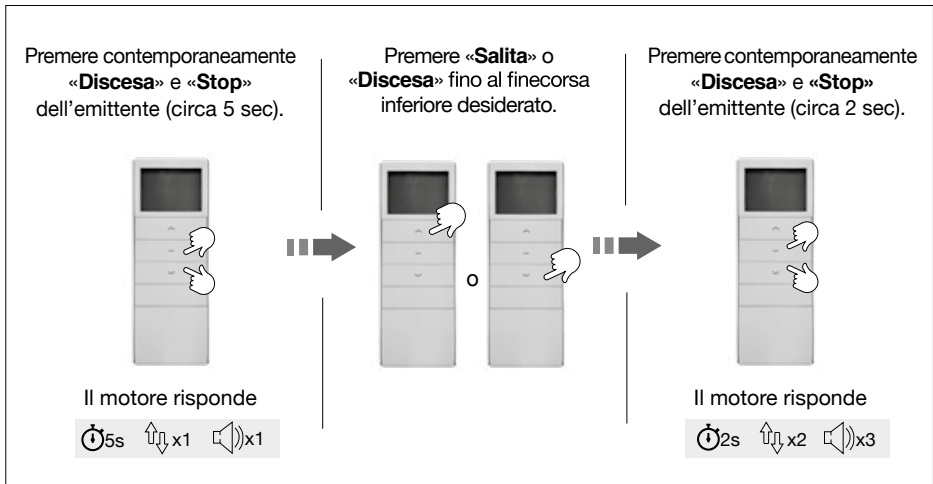

3. Aggiunta di nuovo emittente

A Emittente o canale programmato

B Nuovo emittente o canale da associare

3.1 Metodo 1

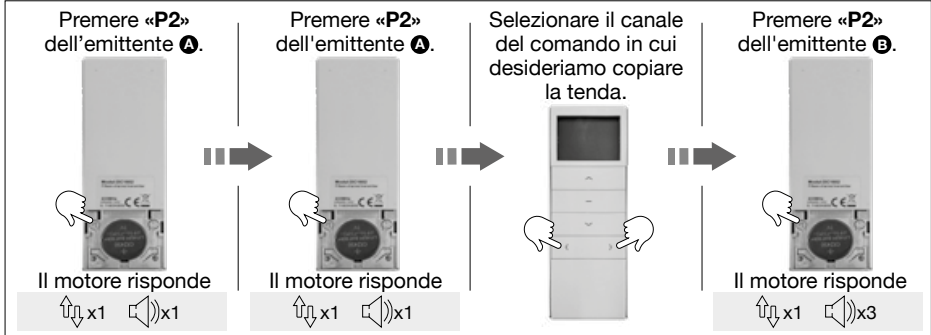

3.2 Metodo 2 o perdita dell'emittente

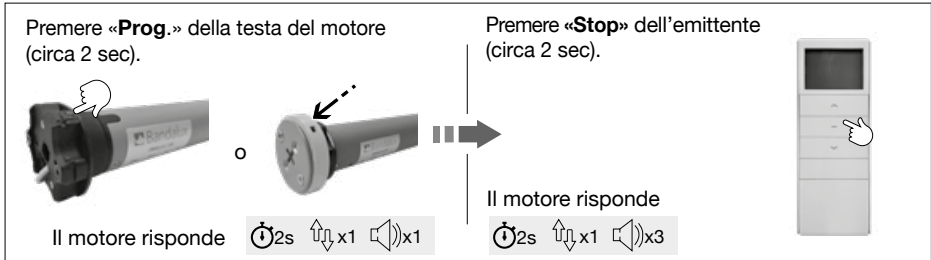

4. Cancellazione di un emittente

A Emittente o canale programmato che desideriamo conservare

B Emittente o canale programmato che desideriamo eliminare

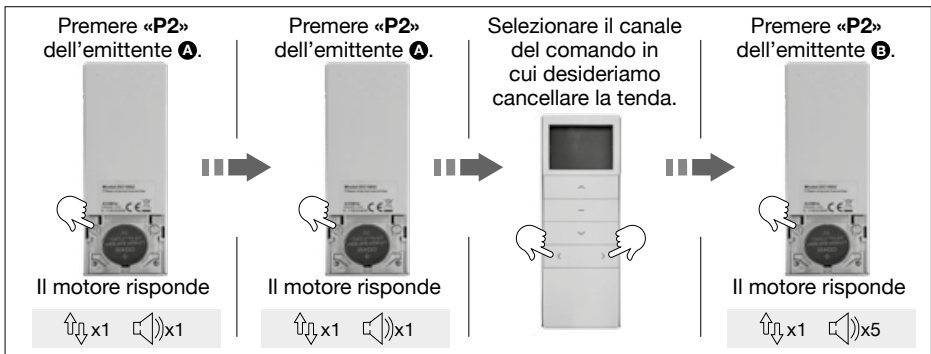

5. Posizione preferita

5.1 Regolazione della posizione preferita

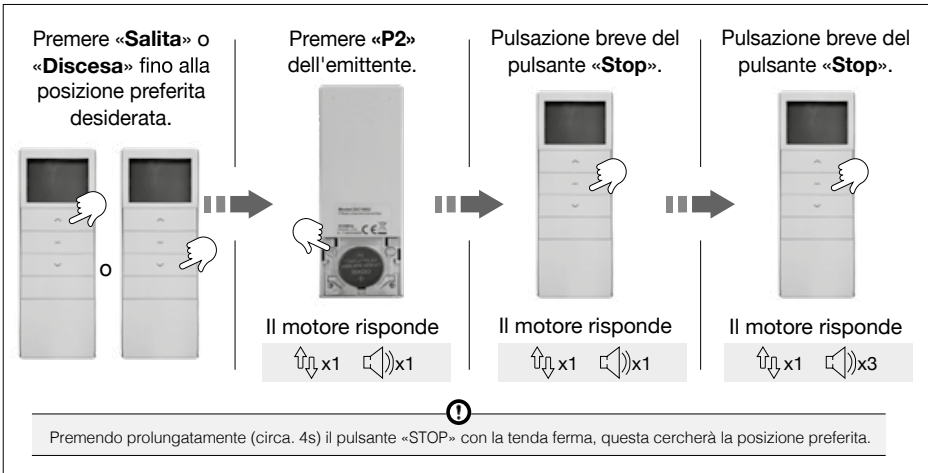

5.2 Eliminazione della posizione preferita

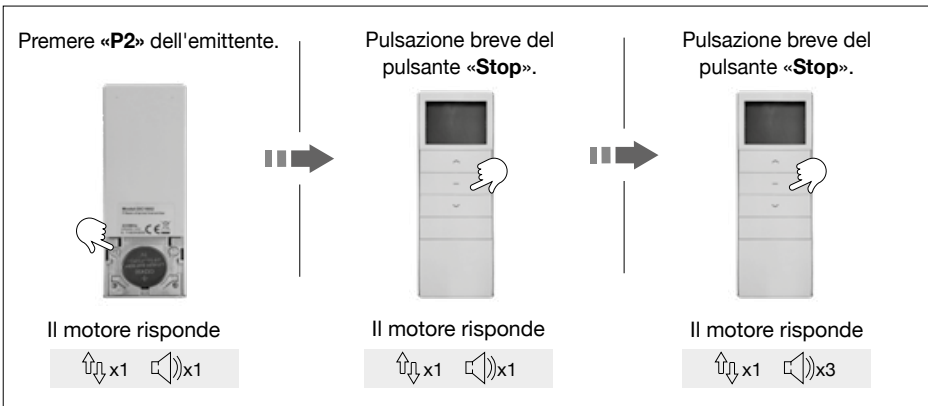

6. Cancellazione totale del motore (RESET)

Premere «Prog» della testa del motore (circa 14 sec).

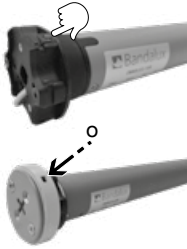

Il motore risponde

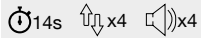

7. Programmazione di un motore dall'inizio

7.1 Assegnazione dell'emittente

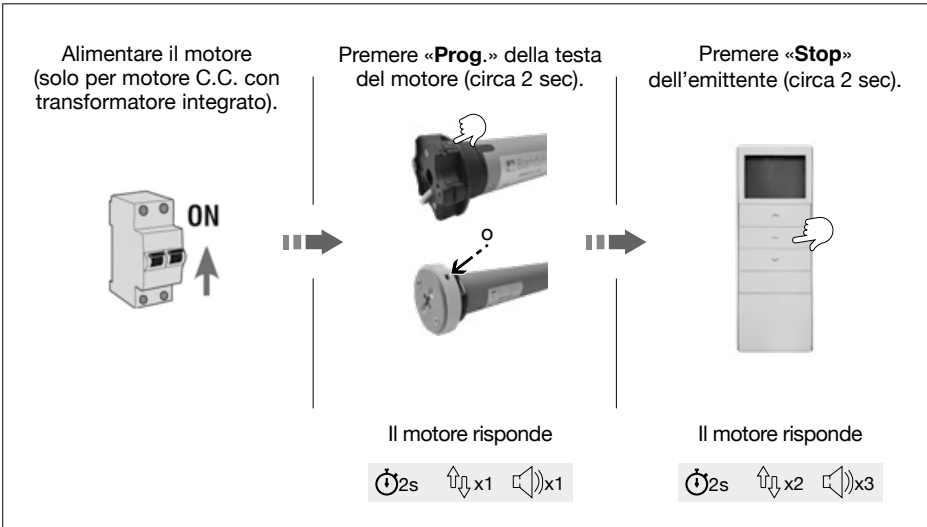

7.2 Verifica del senso di rotazione

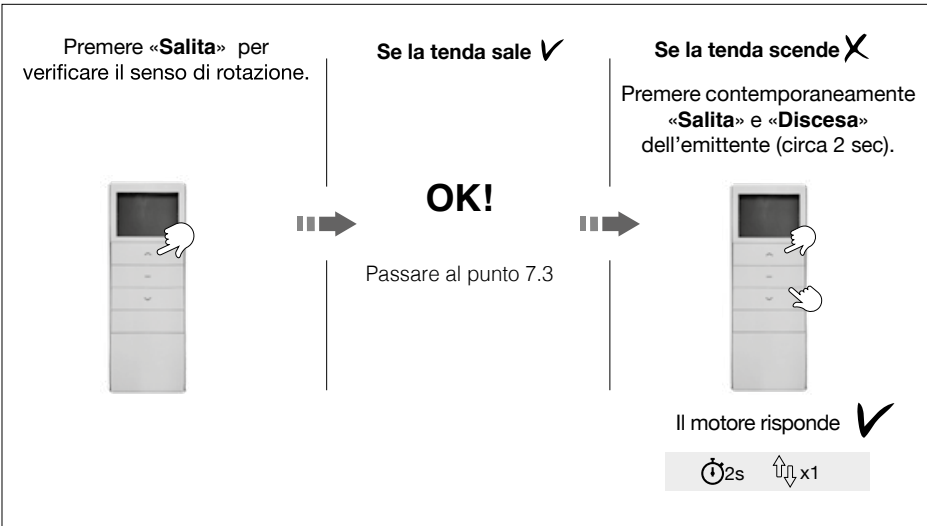

7. Programmazione di un motore dall'inizio

7.3 Regolazione dei finecorsa e chiusura programmazione

FINECORSO SUPERIORE

Premere «**Salita**»
dell'emittente.



Premere «**Stop**»
dell'emittente al finecorsa
superiore desiderato.



Premere
contemporaneamente
«**Salita**» e «**Stop**»
dell'emittente (circa 2 sec).



Il motore risponde

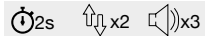

FINECORSO INFERIORE

Premere «**Discesa**»
dell'emittente.



Premere «**Stop**»
dell'emittente al finecorsa
inferiore desiderato.



Premere
contemporaneamente
«**Discesa**» e «**Stop**»
dell'emittente (circa 2 sec).



Il motore risponde

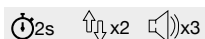

8. Funzioni pulsante «Prog.» testa del motore



Premere «Prog.» della testa del motore il tempo necessario in base all'azione da realizzare, secondo tappe successive:

Movimento motore; Sleep Mode OFF

Inizio programmazione; aggiungere un nuovo emittente

Il motore risponde

x1 x1

Sleep Mode ON

Il motore risponde

x1 x1 x2

Cambio del senso di rotazione

Il motore risponde

x1 x1 x1 x3

Reset motor

Il motore risponde

x1 x1 x1 x1 x4

IT

CONTENTS

Characteristic of remote control	44
1. Installation process of shades	45
1.1 Option 1, fully programmed shades	45
1.2 Option 2, shades in programming mode	45
2. Modify end of rail	46
2.1 Modify end of top rail	46
2.2 Modify end of lower rail	46
3. Adding a new remote control	47
3.1 Method 1	47
3.2 Method 2 or loss of remote control	47
4. Erasing a remote control	47
5. Preferred position	48
5.1 Adjusting preferred position	48
5.2 Eliminating preferred position	48
6. Completely erasing the motor (reset)	49
7. Programming motor from the beginning	50
7.1 Assigning remote control	50
7.2 Checking direction of rotation	50
7.3 Regulating end of rail and closing programming	51
8. Button functions prog. Motor head	52

Characteristic of remote control

Radio signal range: 100 meters without obstacles.
20 meters crossing through 2 structural concrete walls.

Maximum number of remote controls or channels associated with a single motor: 9 remote controls or channels.

Maximum number of motors associated with a single remote control or channel: Unlimited



SINGLE-CHANNEL TRANSMITTER

- ❶ Rolling up
- ❷ Stop and preferred position
- ❸ Rolling down
- ❹ P2



15 CHANNEL TRANSMITTER

Channel 0 is not associate; everything that we associate with other channels is associated with this channel automatically.

- ❶ Rolling up
- ❷ Stop and preferred position
- ❸ Rolling down
- ❹ Channel selection: Downward
- ❺ Channel selection: Upward
- ❻ P2

1. Installation procedure

1.1 Option totally programmed shades

FOR THE FOLLOWING ORDERS

1 shade with 1 single remote control OR Orders from **more than 1 shade with more than one remote control**, where the **remote control-shade association is specified**.

Power the motor (only for C.C motors with integrated transformer).

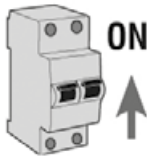

The motor already works with the programmed ends of rail.

1.2 Option shades in programming mode

FOR THE FOLLOWING ORDERS

Ordering **multiple shades with multiple remote controls**, where **the association of the remote controls is not specified**.

Only connect the shade that we are going to program, never connect more than one shade to perform this step of the manual.

Power the motor (only for C.C motors with integrated transformer).



Press «**Prog.**» on the motor head (approx 2 sec).

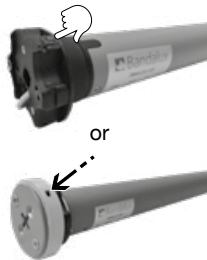

The motor responds

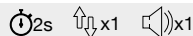

Press «**Stop**» on the remote control (approx 2 sec).



The motor responds

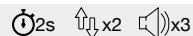

2. Modification of end of rail



To adjust the ends of the rail that are already programmed by according to customer specifications.

2.1 Modify end of top rail

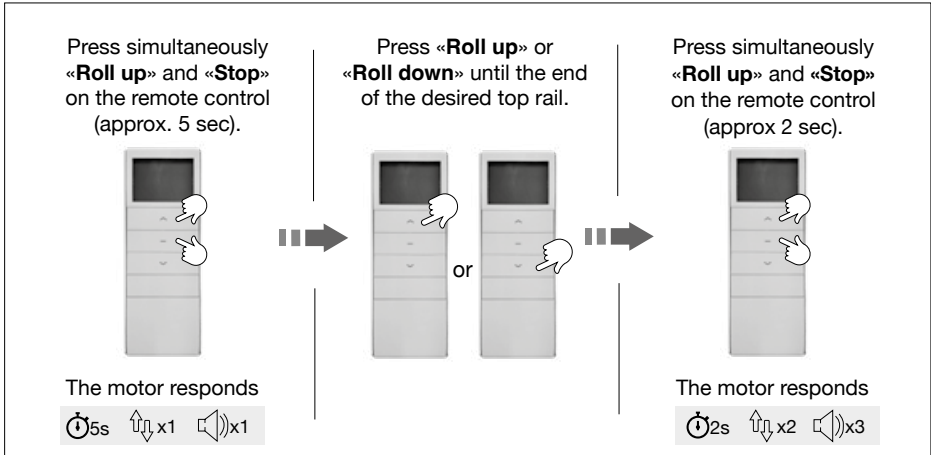

EN

2.2 Modify end of lower rail

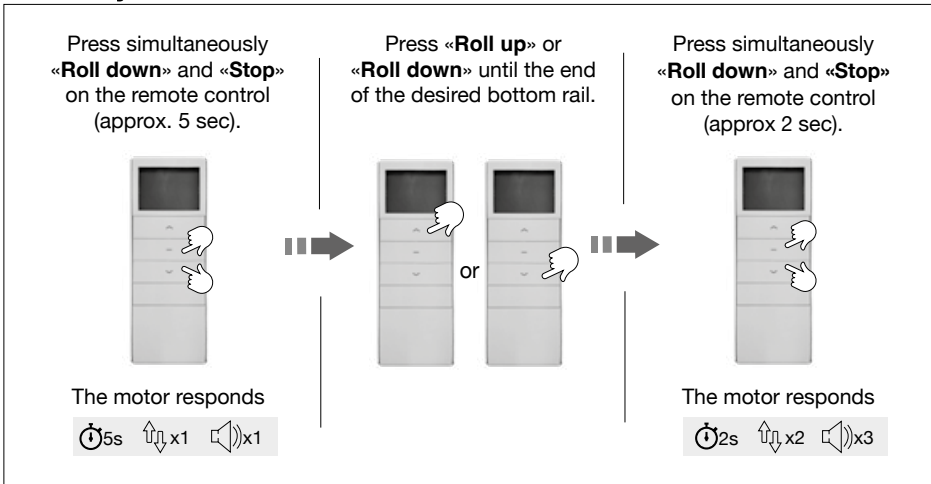

3. Adding a new remote control

- A** Programmed remote control or channel **B** New remote control or channel to adhere

3.1 Method 1

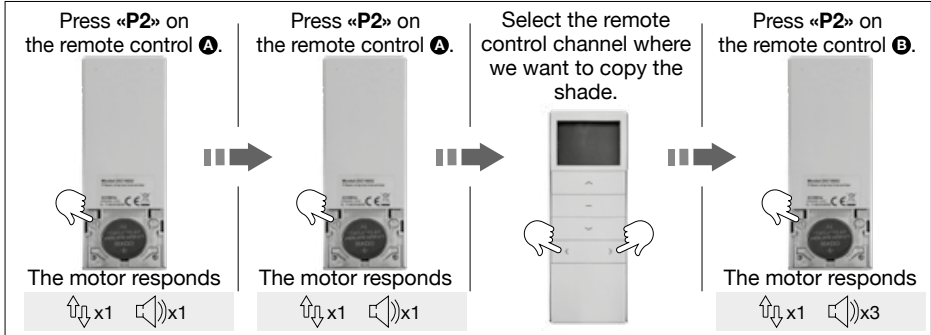

3.2 Method 2 or loss of remote control

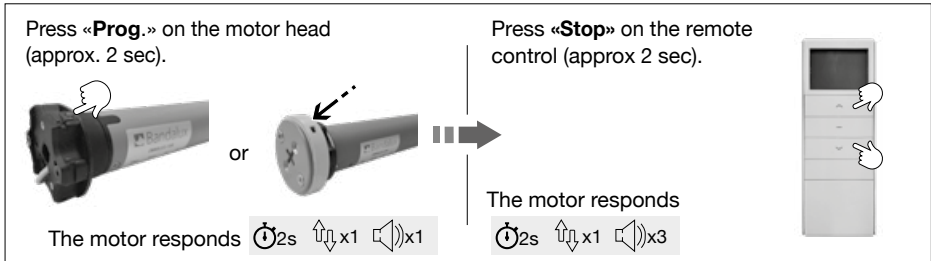

EN

4. Erasing a remote control

- A** Remote control or programmed channel we want to keep **B** Remote control or programmed channel we want to delete

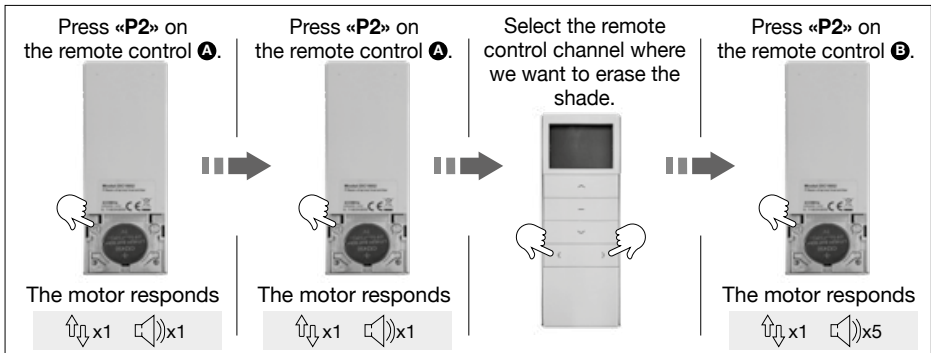

5. Preferred position

5.1 Adjusting preferred position

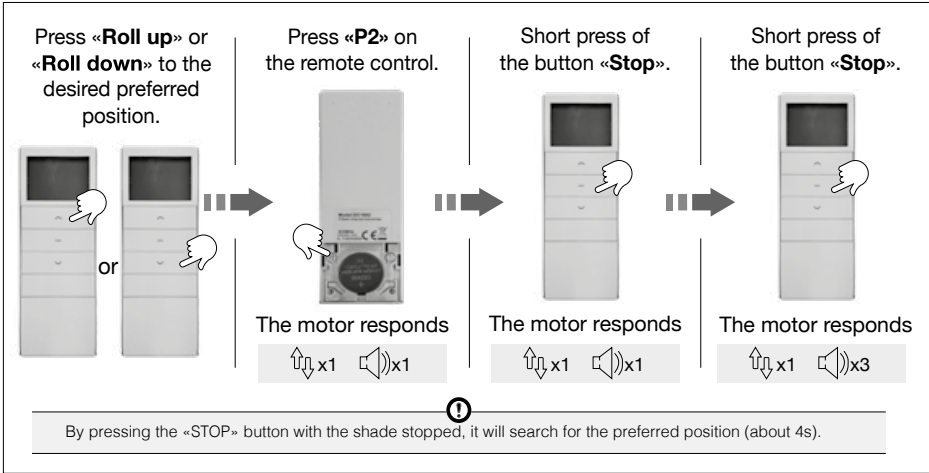

5.2 Eliminating preferred position

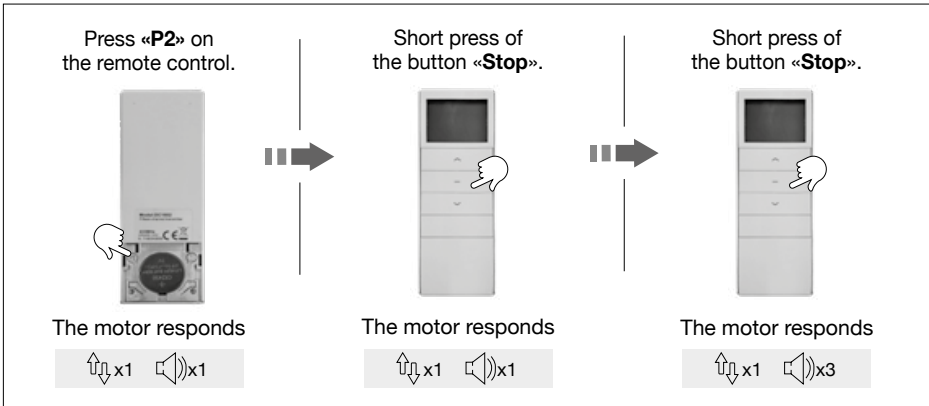

6. Completely erasing the motor (RESET)

Press «Prog» on the motor head (approx 14 sec).

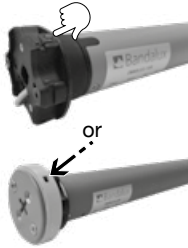

The motor responds

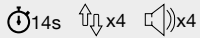

7. Programming a motor from the start

7.1 Assigning remote control

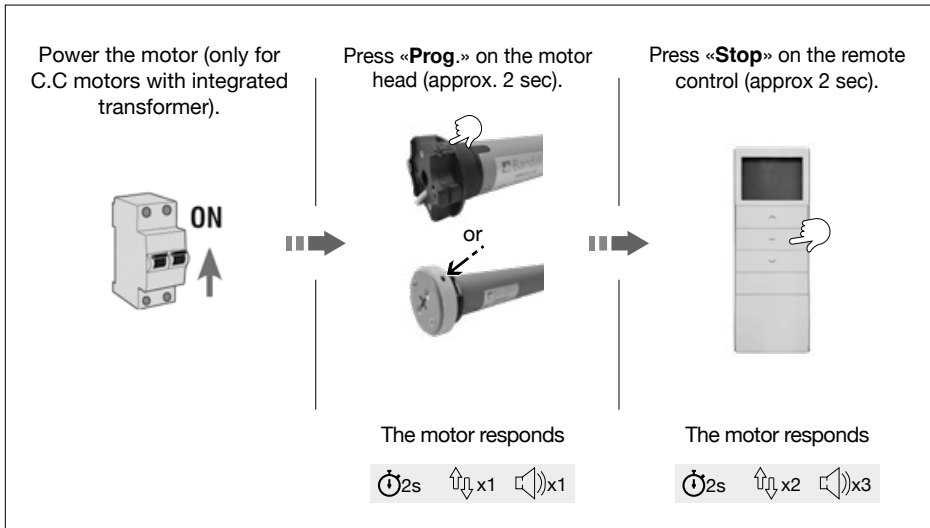

EN

7.2 Checking the direction of rotation

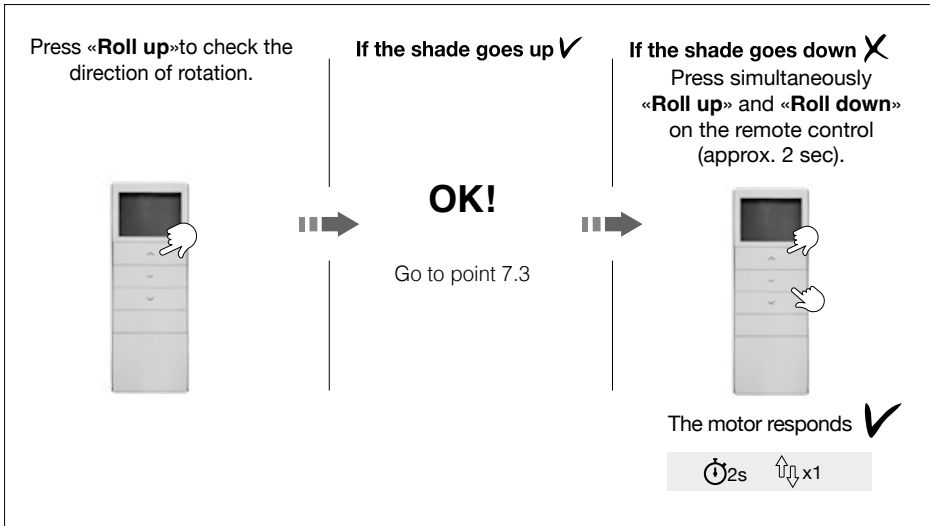

7. Programming a motor from the start

7.3 Regulating end of rail and closing programming

TOP LIMIT SWITCH

Press «**Roll up**» on the remote control.



Press «**Stop**» on the remote control at the end of the desired top rail.



Press simultaneously «**Roll up**» and «**Stop**» on the remote control (approx. 2 sec).



The motor responds

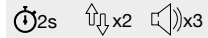

BOTTOM LIMIT SWITCH

Press «**Roll down**» on the remote control.



Press «**Stop**» on the remote control at the end of the desired bottom rail.



Press simultaneously «**Roll down**» and «**Stop**» on the remote control (approx. 2 sec).



The motor responds

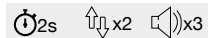

EN

8. Functions button «Prog.» motor head



or



Press «**Prog.**» on the motor head for the time required based on the desired action, according to the following steps:

 **Motor movement;
Sleep Mode OFF**

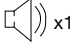

Start programming; add a new remote control

The motor responds

 x1  x1

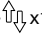

Sleep Mode ON

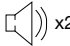
The motor responds

  x1  x1  x2

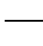
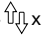

Change rolling direction

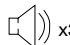
The motor responds

  x1  x1  x1  x3

Reset motor

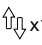
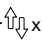
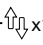
The motor responds

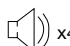
  x1  x1  x1  x1  x4

EN